

ROHS

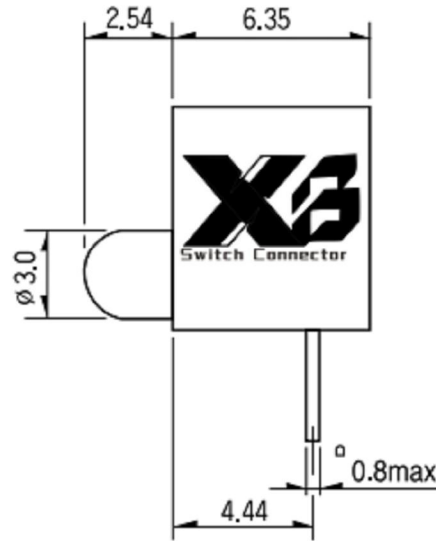

P.C.B DIMENSION

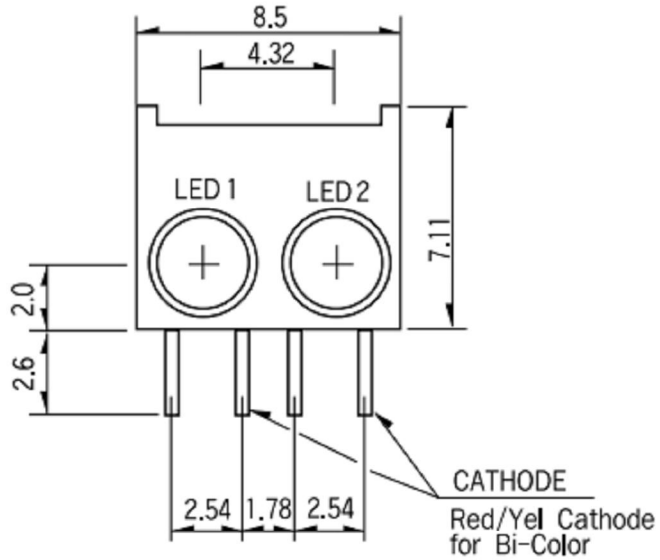
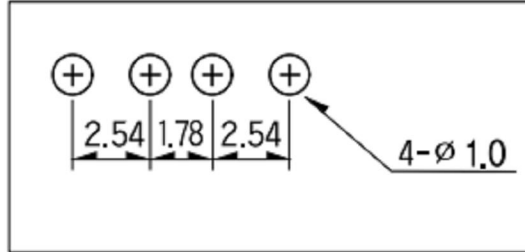

* Reverse Cathode Left : SAE-01 G
Housing Color : Gray

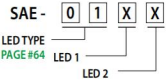

| Number | 0 | 1 (Bi-Color) | 2 | 3 | 4 (Bi-Color) | 8 | 9 |
|--------|-------|-----------------|-------|--------|----------------------|------|-------|
| Color | Blank | Red (Red/Green) | Green | Yellow | Amber (Yellow/Green) | Blue | White |

| Package | LED TYPE | Part No. | Chip | | Lens | | Absolute Maximum Ratings | | Electro-optical Data(At 20mA) | | Viewing Angle 2θ (1/2°) | | | | |
|-----------------------------------|----------------------------------|--------------|---------------|----------------------|-----------------|-----------------|--------------------------|---------|-------------------------------|---------------|-------------------------|---------------|------|------|---|
| | | | Emitted Color | Peak Wav Length (nm) | Appearance | ΔI (mV) | Pd (mW) | If (mA) | Vf (V) | Iv Typ. (mcd) | | Iv Max. (mcd) | | | |
| High Efficiency | 01 | BL-B2141K | Green | 568 | Green Diffused | 30 | 100 | 30 | 150 | 2.2 | 2.6 | 30.0 | 50 | | |
| | | BL-B3141K | Yellow | 585 | Yellow Diffused | 35 | 100 | 30 | 150 | 2.1 | 2.6 | 20.0 | 50 | | |
| | | BL-BA1141K | Amber | 610 | Amber Diffused | 35 | 100 | 30 | 150 | 2.0 | 2.6 | 60.0 | 50 | | |
| | | BL-DB141K | Bright Red | 700 | Red Diffused | 90 | 50 | 15 | 50 | 2.2 | 2.6 | 10.0 | 50 | | |
| | | BL-DB41Y1E | Super Blue | 470 | Blue Diffused | 30 | 100 | 30 | 100 | 3.5 | 4.0 | 550 | 45 | | |
| | Low Current | 02 | BL-B5141K-L | Hi-Eff Red | 635 | Red Diffused | 45 | 15 | 7 | - | 1.7 | 2.2 | 4.5 | 50 | |
| | | | BL-B2141K-L | Green | 568 | Green Diffused | 30 | 16 | 7 | - | 1.0 | 2.3 | 7.0 | 50 | |
| | | | BL-B3141K-L | Yellow | 585 | Yellow Diffused | 35 | 15 | 7 | - | 1.8 | 2.2 | 3.5 | 50 | |
| | | | BR-B451K-05V | Hi-Eff Red | 635 | Red Diffused | - | - | 8 | - | - | - | - | 15.5 | - |
| | | | BR-B214K-05V | Green | 568 | Green Diffused | - | - | 8 | - | - | - | - | 15.5 | - |
| Integral Resistor 5V | 03 | BR-B314K-05V | Yellow | 585 | Yellow Diffused | - | - | 8 | - | - | - | 14.0 | - | | |
| | | BR-B414K-05V | Orange | 635 | Orange Diffused | - | - | 8 | - | - | - | 15.5 | - | | |
| | | BL-BEX271E | Hi-Eff Red | 635 | White Diffused | 45 | 100 | 30 | 150 | 2.0 | 2.6 | 25.0 | 45 | | |
| | | BL-BYX271E | Green | 568 | White Diffused | 35 | 100 | 30 | 150 | 2.1 | 2.6 | 20.0 | 45 | | |
| 1.0" Lead Flangeless 4.82 | 01 | BL-B5133N | Bright Red | 700 | Red Diffused | 90 | 50 | 15 | 50 | 2.2 | 2.6 | 50.0 | 40 | | |
| | | BL-B2133N | Green | 568 | Green Diffused | 30 | 100 | 30 | 150 | 2.2 | 2.6 | 65.0 | 40 | | |
| | | BL-B3133N | Yellow | 585 | Yellow Diffused | 35 | 100 | 30 | 150 | 2.1 | 2.6 | 50.0 | 40 | | |
| | | BL-B5134N | Bright Red | 700 | Red Diffused | 90 | 50 | 15 | 50 | 2.2 | 2.6 | 13.0 | 45 | | |
| | | BL-B2134N | Green | 568 | Green Diffused | 30 | 100 | 30 | 150 | 2.2 | 2.6 | 90.0 | 45 | | |
| | T-1 3/4 1.0" Lead Flangeless 5.0 | 07 | BL-B3134N | Yellow | 585 | Yellow Diffused | 35 | 100 | 30 | 150 | 2.1 | 2.6 | 70.0 | 45 | |
| | | | BL-BB41R4N | Super Blue | 470 | Blue Diffused | 30 | 100 | 30 | 100 | 3.5 | 4.0 | 550 | 45 | |
| | | | BL-BEG274N | Hi-Eff Red | 635 | White Diffused | 45 | 100 | 30 | 150 | 2.0 | 2.6 | 45.0 | 45 | |
| | | | BL-BYG274N | Yellow | 585 | White Diffused | 35 | 100 | 30 | 150 | 2.1 | 2.6 | 35.0 | 45 | |
| | | | BL-BYG274N | Green | 568 | White Diffused | 30 | 100 | 30 | 150 | 2.2 | 2.6 | 50.0 | 45 | |
| T-1 3/4 1.0" Lead Standard 5.0 | 07 | BL-BEG204 | Hi-Eff Red | 635 | White Diffused | 45 | 100 | 30 | 150 | 2.0 | 2.6 | 35.0 | 40 | | |
| | | BL-BYG204 | Yellow | 585 | White Diffused | 35 | 100 | 30 | 150 | 2.1 | 2.6 | 30.0 | 40 | | |
| | | BL-BYG204 | Green | 568 | White Diffused | 30 | 100 | 30 | 150 | 2.2 | 2.6 | 45.0 | 40 | | |
| | | BL-BYG204 | Green | 568 | White Diffused | 30 | 100 | 30 | 150 | 2.2 | 2.6 | 45.0 | 40 | | |
| 2.0x5.0x7.0 1.0" Lead Rectangular | 07 | BL-BW7302B-R | Hi-Eff Red | 635 | Water Clear | 45 | 100 | 30 | 150 | 2.0 | 2.6 | 4.0 | 80 | | |
| | | BL-BW7302B-R | Green | 568 | Water Clear | 30 | 100 | 30 | 150 | 2.2 | 2.6 | 4.5 | 80 | | |

| Measuring items | Symbol | Measuring conditions | Judgment criteria for failure |
|--------------------|----------------------|----------------------|-------------------------------|
| Forward voltage | V _f (V) | I _f =20mA | Over U'x1.2 |
| Reverse current | I _r (μA) | V _r =5V | Over U'x2 |
| Luminous intensity | I _v (mcd) | I _f =20mA | Below S'X0.5 |



东莞市溪榜电子有限公司
DONG GUAN XI BANG ELECTRONICS CO., LTD

TITLE : XB LED模块系列 XB LED MODULE Series

MODEL : XB-SAE-01xx

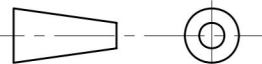

TOLERANCE
<=1.5mm ±0.1
>1.5mm ±0.2
>=10mm ±0.3

ANGLE TOL
±2°

| | | | | | |
|---------------|-------|------------|---------------|----------|----------|
| UNIT : MM | DWN. | ZENQ. CHEN | DATE | 2024-4-8 | |
| SCALE : 7 : 1 | CHK'D | DONG. PANG | DATE | 2024-4-8 | |
| VERSION | 01 | APPD. | FEI. LONG. HE | DATE | 2024-4-8 |

| | | | | |
|-----|-----------|-----------|-----|-----------|
| 2 | TERMINAL | PBS STRIP | 3 | Au PLATED |
| 1 | CASE | PBT | 1 | BLACK |
| NO. | PART NAME | MATERIAL | QTY | FINISHING |