

F

E

D

C

B

A

F

E

D

C

B

A

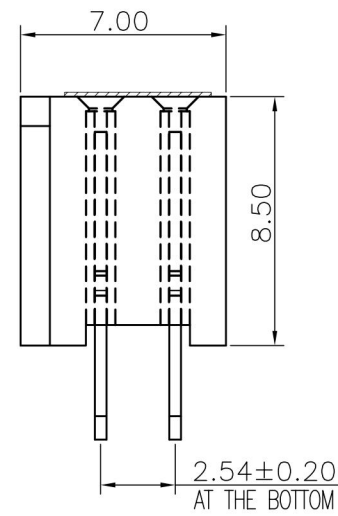
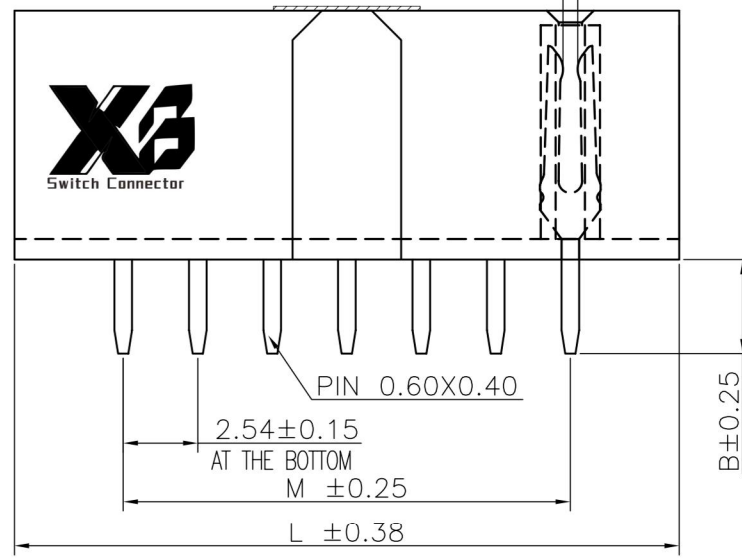
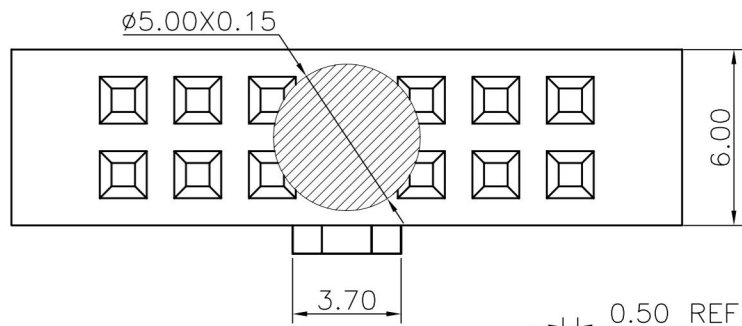

Specifications
 Current Rating:3.0Amp
 Insulation Resistance:1000MΩMin.
 Dielectric Withstanding Voltage:600VAC
 Contact Resistance:20mΩMax.
 Operating Temperature:-40°C to +105°C
 Materials
 Contact Material:
 Phosphor Bronze
 Insulator Material:
 PBT(Not resistant to high temperature),
 Nylon(High temperature resistance),
 LCP(High temperature resistance),
 UL 94V-0
 All materials must meet XI BANG
 hazardous substances control standards.

No. of PIN/ROW	Dimension Information	
	M	L
03	5.08	12.50
04	7.62	15.04
05	10.16	17.58
06	12.70	20.12
07	15.24	22.66
08	17.78	25.20
09	20.32	27.74
10	22.86	30.28
11	25.40	32.82
12	27.94	35.36
13	30.48	37.90
14	33.02	40.44
15	35.56	42.98
16	38.10	45.52
17	40.64	48.06
18	43.18	50.60
19	45.72	53.14
20	48.26	55.68
21	50.80	58.22
22	53.34	60.76
23	55.88	63.30
24	58.42	65.84
25	60.96	68.38
26	63.50	70.92
27	66.04	73.46
28	68.58	76.00
29	71.12	78.54
30	73.66	81.08
31	76.20	83.62
32	78.74	86.16
33	81.28	88.70
34	83.82	91.24
35	86.36	93.78
36	88.90	96.32

Recommended P.C.Board Layout
 (Tolerance:±0.05)

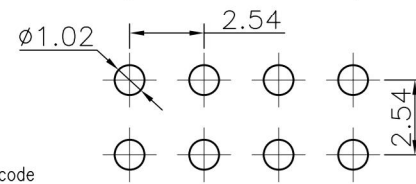

Ordering Information

XB-PM-A-254-217

- Plastic specifications
 - 1=Single row
 - 2=Dual row
 - 3=Tripe row
 - 4=Quadruple
- Water code
- No. of Pins per Row 03~36
- Positioning column information
 - A=No locating post
 - B=Round post
 - C=Square post
- Plating code
 - 01=Tin
 - 02=Gold Flash
 - 05=Gold Flash/Tin
 - 22=Matte Tin
- Pin length See the drawing
- Insulator Material
 - A=PBT
 - R=Nylon(Halogen Free)
 - C=LCP
- Color
 - 1=Black
 - 2=White
 - 3=Yellow
 - E=Beige
- Contact Material A/S/K/T=Phosphor Bronze
- Packing code
 - A=Box
 - B=Tray
 - C=Tube
 - D=Tape&Reel
 - E=Cap+Tube
 - F=Cap+Tape&Reel
 - G=Acetate Tape+Tube
 - H=Acetate Tape+Tape&Reel

东莞市溪榜电子有限公司 DONG GUAN XI BANG ELECTRONICS CO., LTD.	GENERAL TOLERANCE			DWG. NO.	TITLE.
	X.*±5.0°	X.±0.30		XB-PM-A-254-217	
	.X*±3.0°	.X±0.25		PART NO.	
REV. 01	UNIT. mm	SCALE. 4:1	PAGE. 1/1	XB-PM-A-254-217	2.54 FEMALE HEADER DUAL ROWS DIP TYPE CONNECTOR
			.XX*±2.0° .XXX*±1.0°		