

Specifications
 Current Rating:3.0Amp
 Insulation Resistance:1000MΩMin.
 Dielectric Withstanding Voltage:600VAC
 Contact Resistance:20mΩMax.
 Operating Temperature:-40°C to +105°C
 Materials
 Contact Material:Phosphor Bronze
 Insulator Material:
 PBT(Not resistant to high temperature),
 Nylon(High temperature resistance),
 LCP(High temperature resistance),
 UL 94V-0
 All materials must meet Greenconn
 hazardous substances control standards.

No. of PIN/ROW	Dimension Information	
	M	L
02	2.54	5.88
03	5.08	8.42
04	7.62	10.96
05	10.16	13.50
06	12.70	16.04
07	15.24	18.58
08	17.78	21.12
09	20.32	23.66
10	22.86	26.20
11	25.40	28.74
12	27.94	31.28
13	30.48	33.82
14	33.02	36.36
15	35.56	38.90
16	38.10	41.44
17	40.64	43.98
18	43.18	46.52
19	45.72	49.06
20	48.26	51.60
21	50.80	54.14
22	53.34	56.68
23	55.88	59.22
24	58.42	61.76
25	60.96	64.30
26	63.50	66.84
27	66.04	69.38
28	68.58	71.92
29	71.12	74.46
30	73.66	77.00
31	76.20	79.54
32	78.74	82.08
33	81.28	84.62
34	83.82	87.16
35	86.36	89.70
36	88.90	92.24
37	91.44	94.78
38	93.98	97.32
39	96.52	99.86
40	99.06	102.40

Ordering Information

XB-PM-A-254-107

Plastic specifications
 1=Single row
 2=Dual row
 3=Tripe row
 4=Quadruple

Water code

No. of Pins per Row
 02~40

Positioning column information
 A=No locating post
 B=Round post
 C=Square post

Plating code
 01=Tin
 02=Gold Flash
 05=Gold Flash/Tin
 22=Matte Tin

Pin length
 See the drawing

Insulator Material
 A=PBT
 R=Nylon(Halogen Free)
 C=LCP

Color
 1=Black
 2=White
 3=Yellow
 E=Beige

Contact Material
 A/S/K/T=Phosphor Bronze

Packing code
 A=Box
 B=Tray
 C=Tube
 D=Tape&Reel
 E=Cap+Tube
 F=Cap+Tape&Reel
 G=Acetate Tape+Tube
 H=Acetate Tape+Tape&Reel

Recommended P.C.Board
 Layout
 (Tolerance:±0.05)

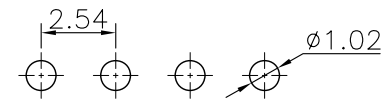

东莞市溪榜电子有限公司
 DONG GUAN XI BANG ELECTRONI CS CO., LTD.

REV. 01 UNIT. mm SCALE. 4:1 PAGE. 1/1

GENERAL TOLERANCE	
X.*±5.0°	X.±0.30
.X*±3.0°	.X±0.25
.XX*±2.0°	.XX±0.15
.XXX*±1.0°	.XXX±0.10

DWG. NO.
XB-PM-A-254-107

PART NO.
XB-PM-A-254-107

TITLE.
 2.54 FEMALE HEADER
 SINGLE ROW DIP TYPE
 CONNECTOR

Specifications

Current Rating : 3.0 Ampere
 Insulation Resistance : 1000 MΩ Min
 Dielectric Withstanding : 600V AC
 Contact Resistance : 20 mΩ Max
 Operating Temperature : -40°C to +105°C

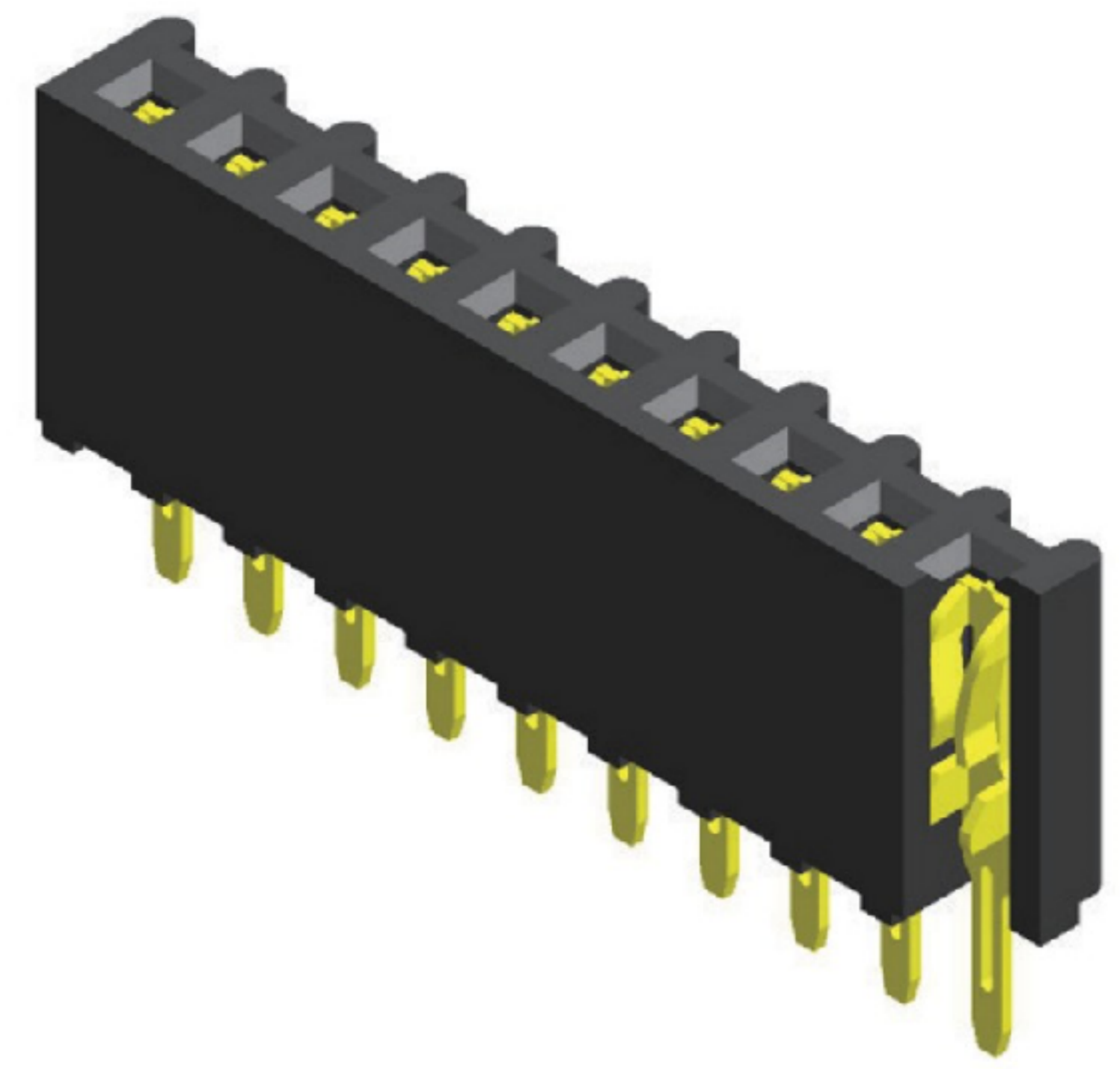

Materials

Contact Material : Phosphor Bronze
 Insulation Material : High Temperature Thermoplastic, 94V-0 PBT

All materials must meet Greenconn's requirements for environmental protection.

Mating with

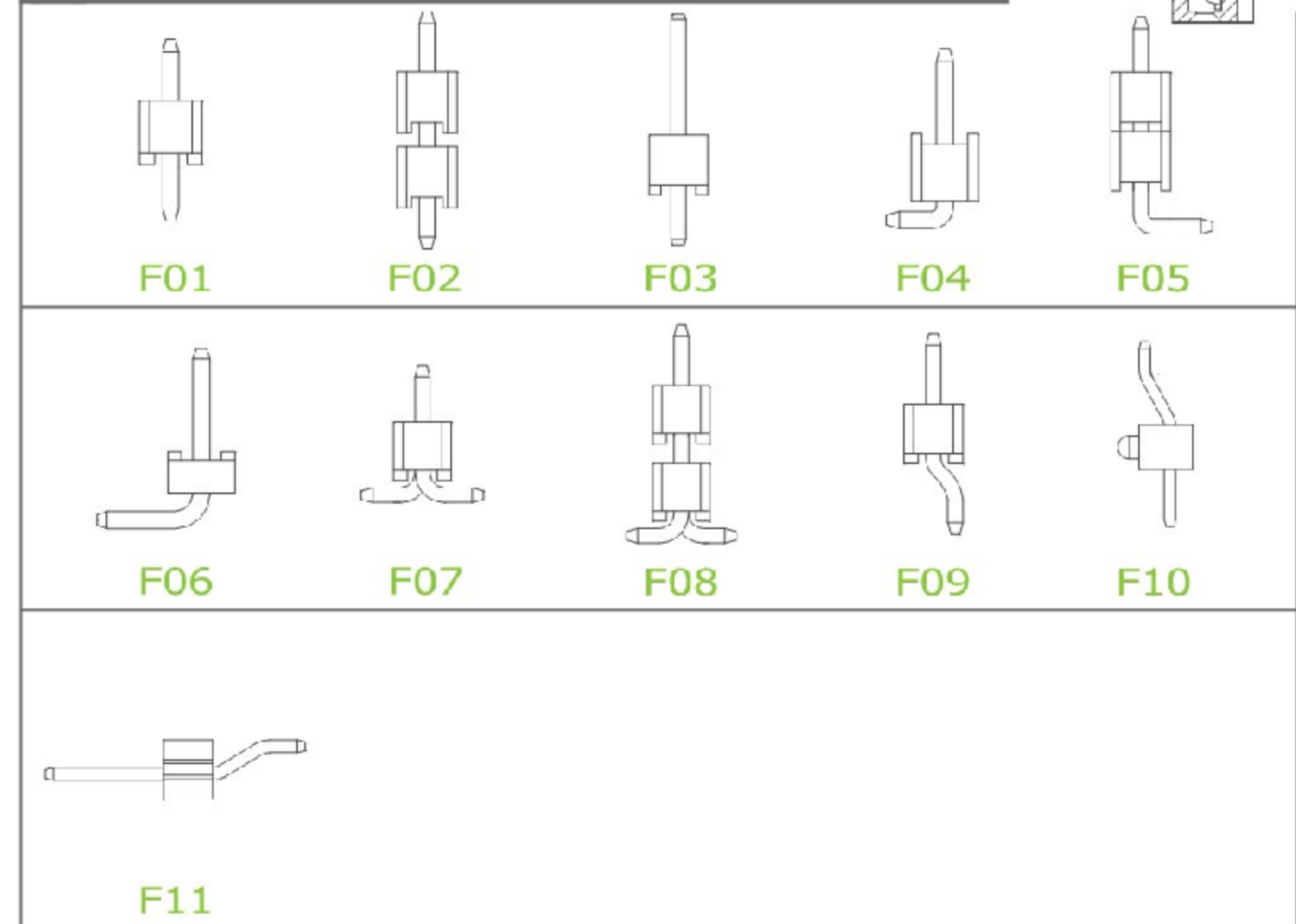

P.S. : Suggested mating pin length : 6.0 ~ 8.0 mm

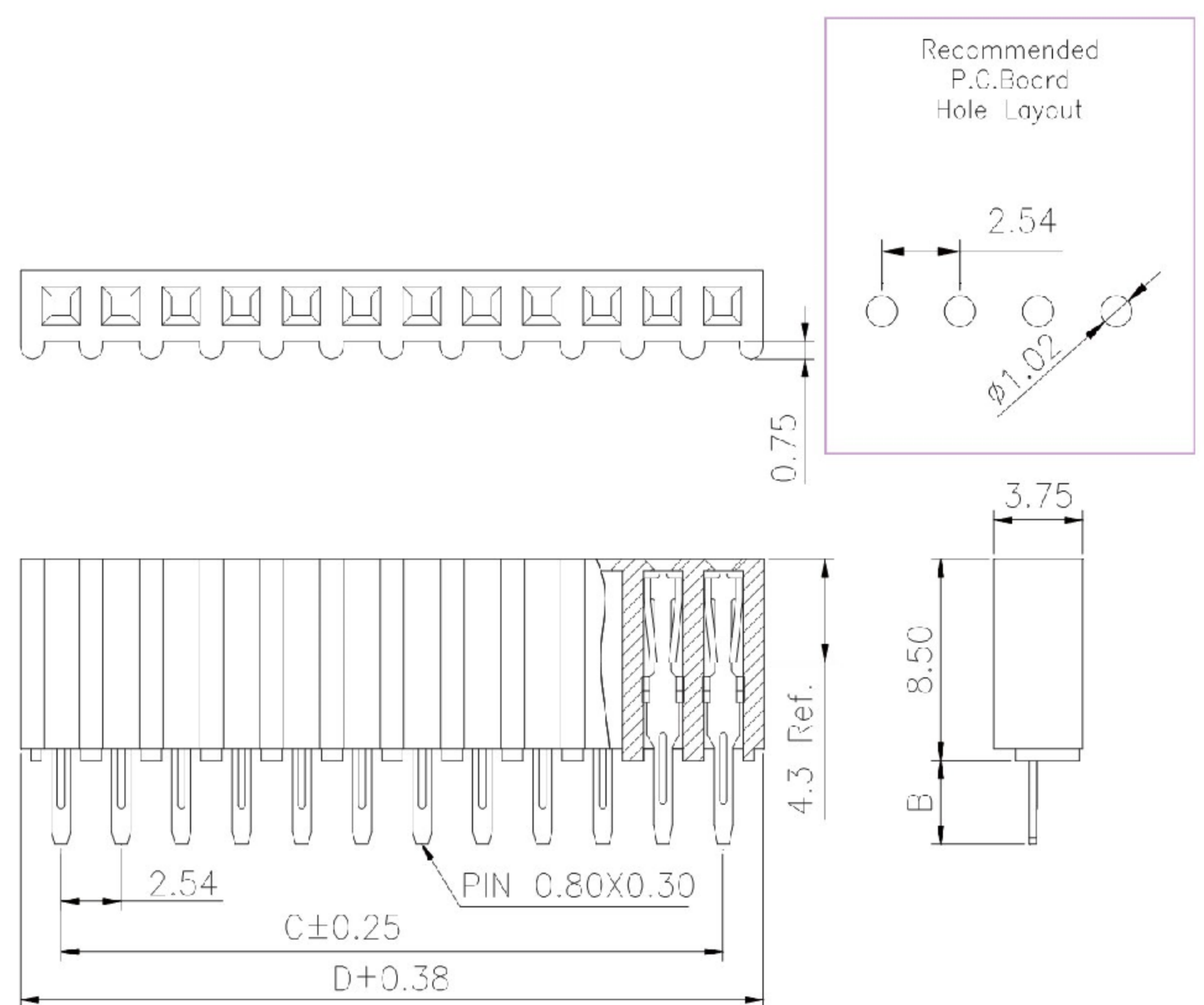

* For Coded Dimension Not Inside The Table, Please Refer To "Ordering Information"

No. of Pins/Row	Dimension Information		No. of Pins/Row	Dimension Information		No. of Pins/Row	Dimension Information		No. of Pins/Row	Dimension Information	
	C	D		C	D		C	D		C	D
02	2.54	5.88	11	25.40	28.74	21	50.80	54.14	31	76.20	79.54
03	5.08	8.42	12	27.94	31.28	22	53.34	56.68	32	78.74	82.08
04	7.62	10.96	13	30.48	33.82	23	55.88	59.22	33	81.28	84.62
05	10.16	13.50	14	33.02	36.36	24	58.42	61.76	34	83.82	87.16
06	12.70	16.04	15	35.56	38.90	25	60.96	64.30	35	86.36	89.70
07	15.24	18.58	16	38.10	41.44	26	63.50	66.84	36	88.90	92.24
08	17.78	21.12	17	40.64	43.98	27	66.04	69.38	37	91.44	94.78
09	20.32	23.66	18	43.18	46.52	28	68.58	71.92	38	93.98	97.32
10	22.86	26.20	19	45.72	49.06	29	71.12	74.46	39	96.52	99.86
			20	48.26	51.60	30	73.66	77.00	40	99.06	102.40

XB 东莞市溪榜电子有限公司
 DONG GUAN XI BANG ELECTRONICS CO., LTD.

REV. 01 UNIT. mm SCALE. 5:1 PAGE. 1/1

GENERAL TOLERANCE	
X'±5.0'	X.±0.30
.X'±3.0'	.X±0.25
.XX'±2.0'	.XX±0.15
.XXX'±1.0'	.XXX±0.10

DESIGN: _____ DATE: _____
 CHECKED: _____ DATE: _____
 AUDITED: _____ DATE: _____
 APPROVED: _____ DATE: _____

DWG. NO. XB-PM-A-254-107
 PART NO. XB-PM-A-254-107

TITLE. 2.00 FEMALE HEADER SINGLE ROW DIP TYPE BASE 4.30H