

ROHS

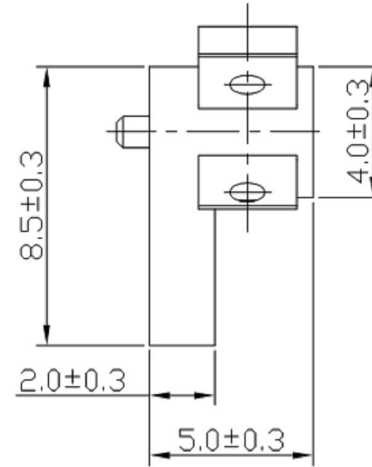

SCHEMATIC

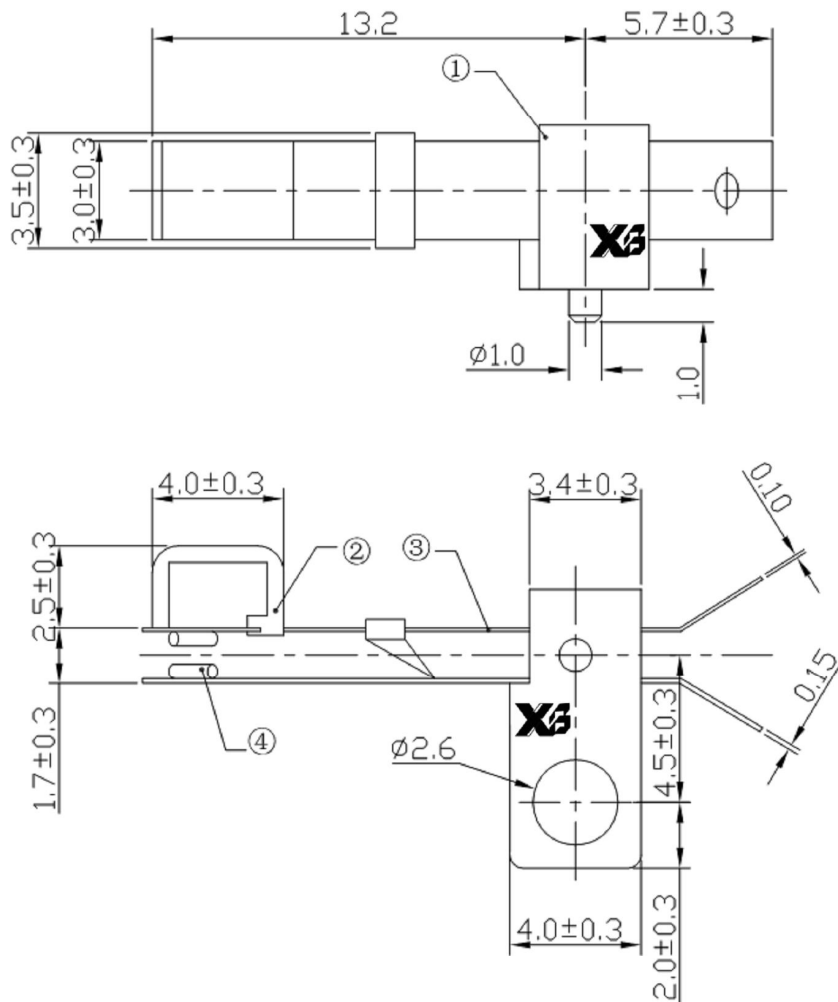

Product material

1. Blade switch
2. Base: POM/PA66
3. Terminal: Phosphorus copper
4. Contact point: Purple copper
5. Electroplating: Silver/Gold Plating
6. Temperature range for use: $-10\text{ }^{\circ}\text{C} \pm 60\text{ }^{\circ}\text{C}$
7. Current and voltage: 0.5A 12V DC
8. Operating force: 30GF \pm 10GF
9. Voltage withstand: 500V 0.5mA/min
10. Insulation resistance: 100M Ω
11. Contact resistance: 30M Ω
12. Lifetime: 50000 times



东莞市溪榜电子有限公司
DONG GUAN XI BANG ELECTRONICS CO., LTD

TITLE : LEAF SWITCH
MODBL : LF-051 (W01053)

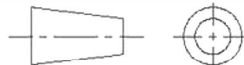

TOLERANCE
 $\leq 5\text{mm} \pm 0.1$
 $> 5\text{mm} \pm 0.2$

ANGLE TOL
 ± 2

UNIT : MM	DWN.	DATE
SCALE : 3 : 1	CHK'D	DATE
VERSION 01	APPD.	DATE

5	CONTACT	COPPER	1	Ag PLATED
4	SPRING	BRASS STRIP	2	Ag PLATED
3	SPRING	PBS	2	NATURE
2	COVER	POM	1	BLACK
1	KNOB	POM	1	BLACK
NO.	PART NAME	MATERIAL	QTY.	FINISHING